

NOTICE DE MONTAGE · ASSEMBLING INSTRUCTION · MONTAGEANLEITUNG

## RAIL EN APPLIQUE · RAIL · SCHIENE

Porte coulissante · Sliding door · Schiebetüre

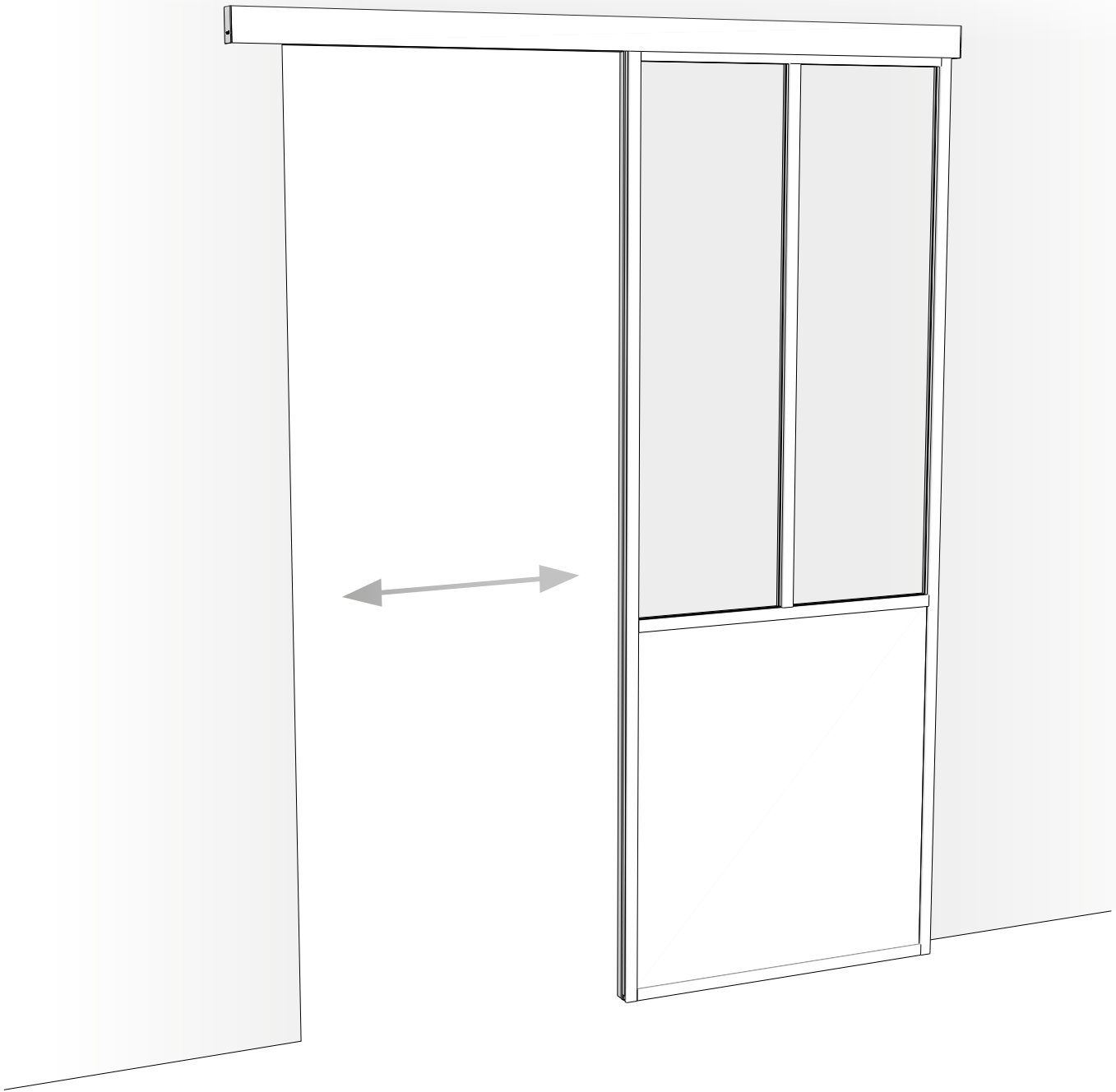

MATÉRIEL NÉCESSAIRE / NEEDED TOOLS / NÖTIGEN WERKZEUGE  
(non fourni / not provided / nicht vorhanden)

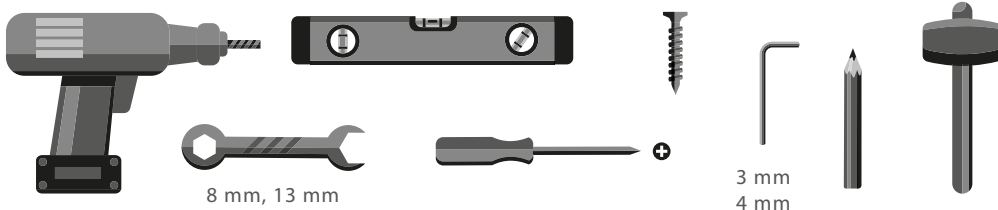

COMPOSITION DE VOTRE COLIS / INCLUDED IN THE PACKAGE / PACKET INHALT

A  
X1



B  
X1



C  
X2

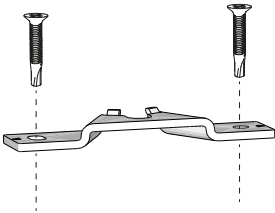

D  
X5

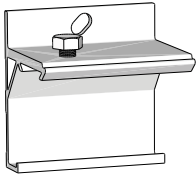

E  
X2

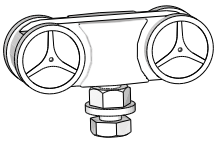

F  
X2

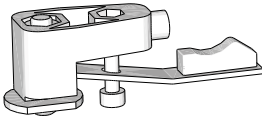

G  
X3



H  
X1

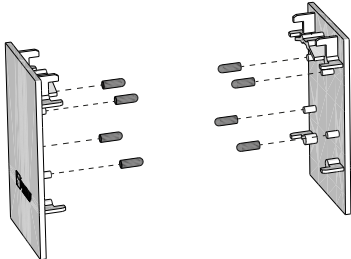

I  
X1

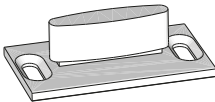

J  
X1



# ÉTAPE 1 - STEP 1 - SCHRITT 1

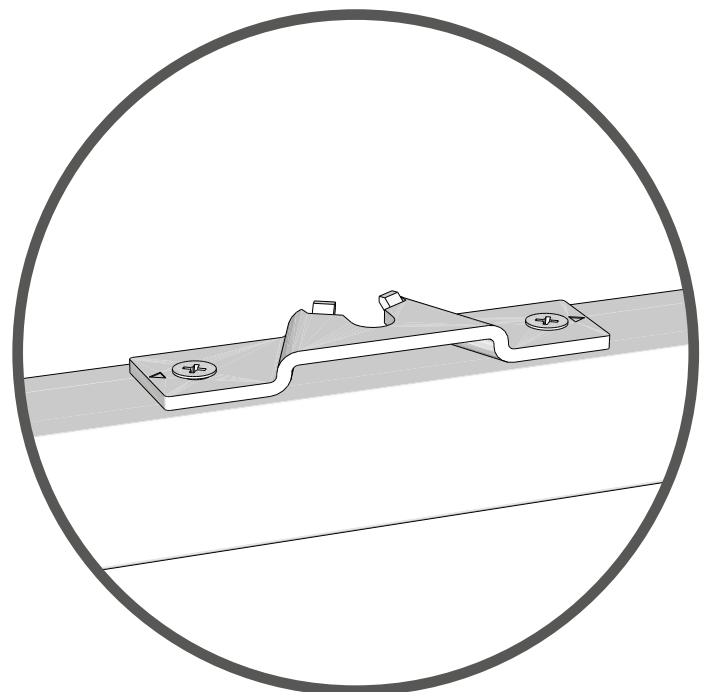
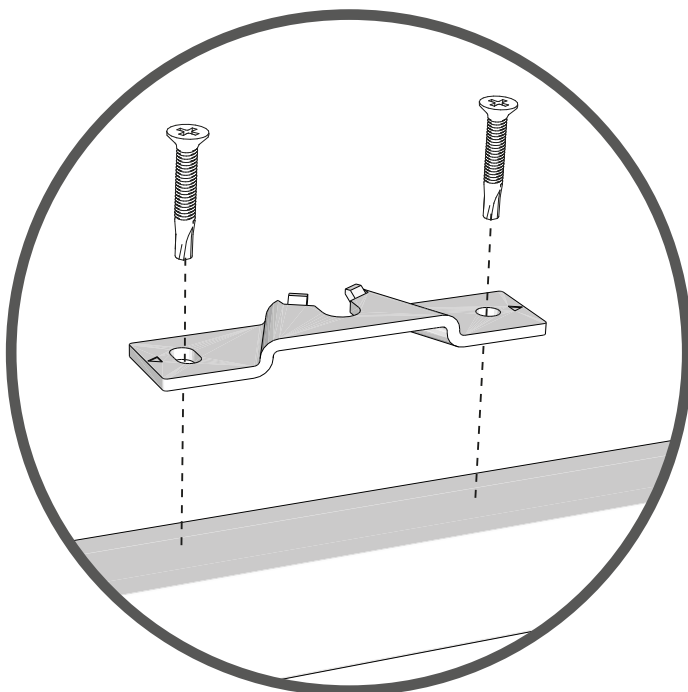
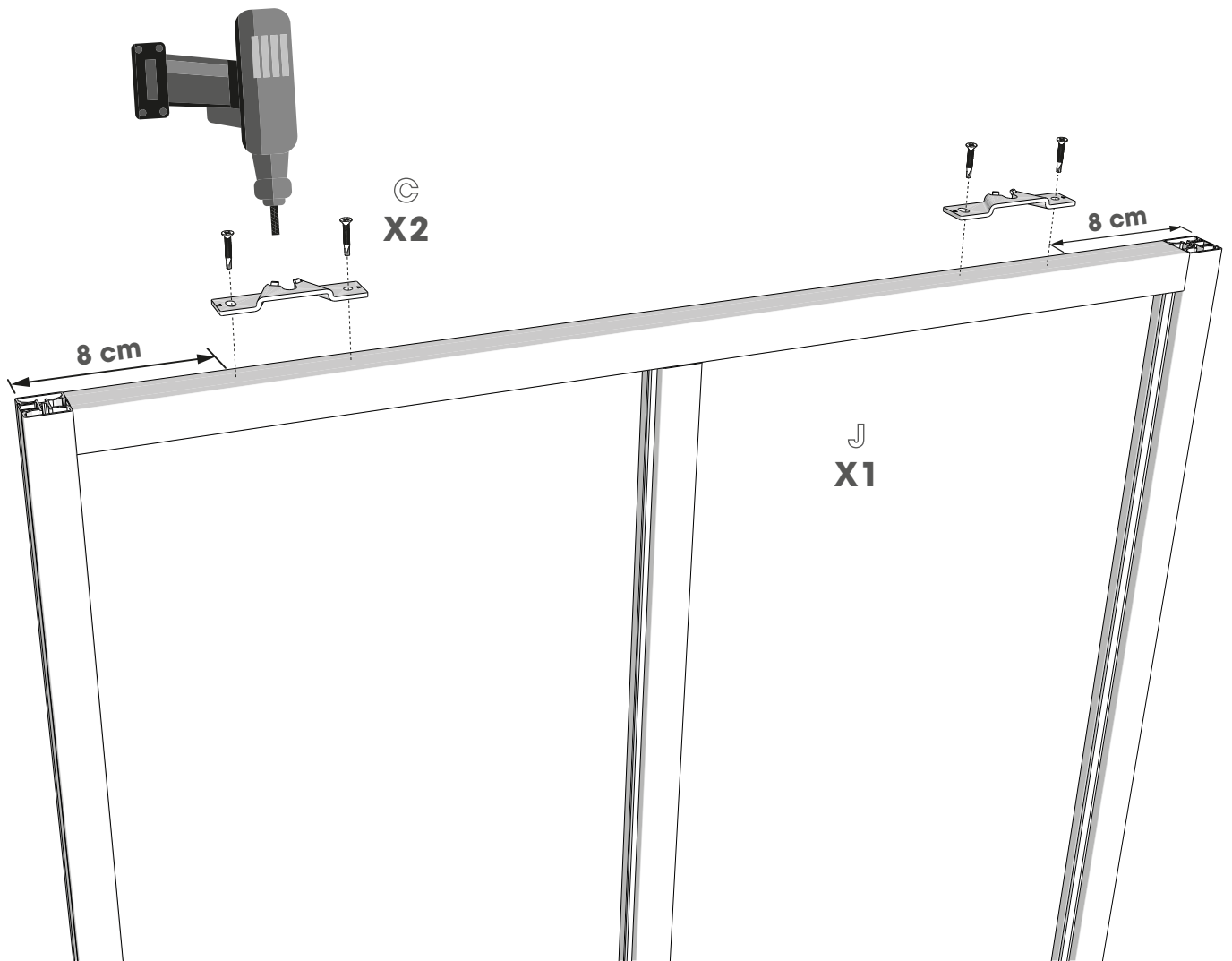
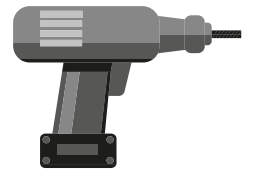

# ÉTAPE 2 - STEP 2 - SCHRITT 2



8 mm

D  
X5

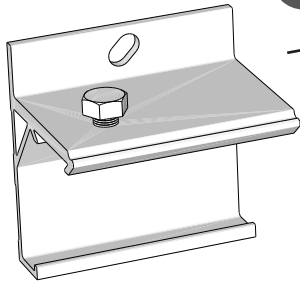

1

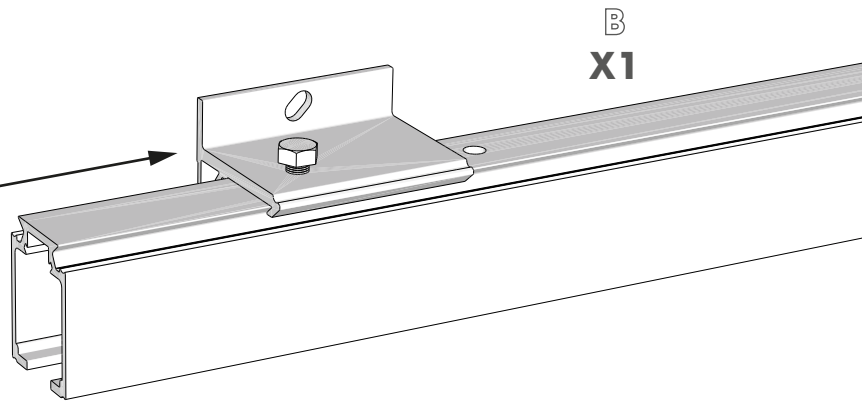

B  
X1

2

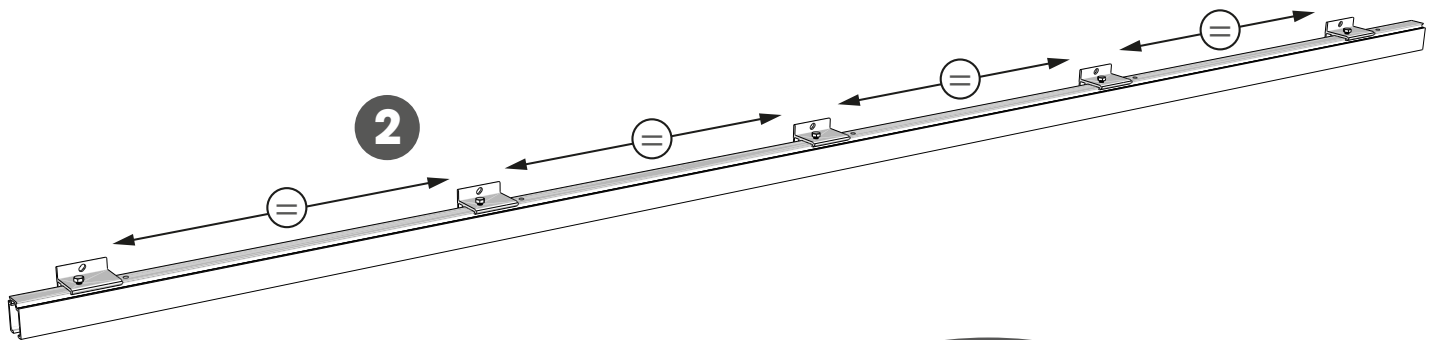

3

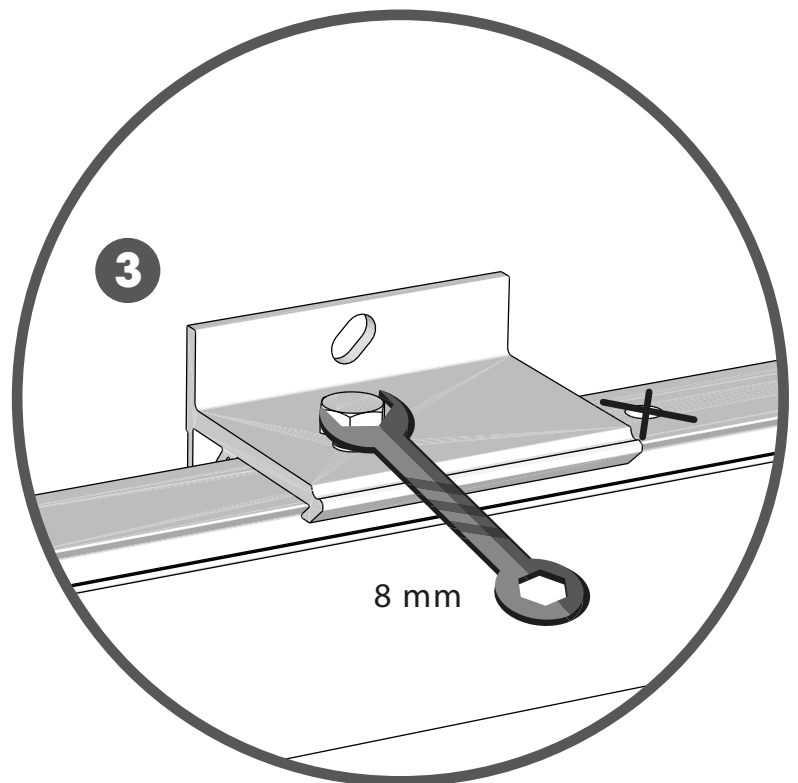

8 mm

# ÉTAPE 3 - STEP 3 - SCHRITT 3

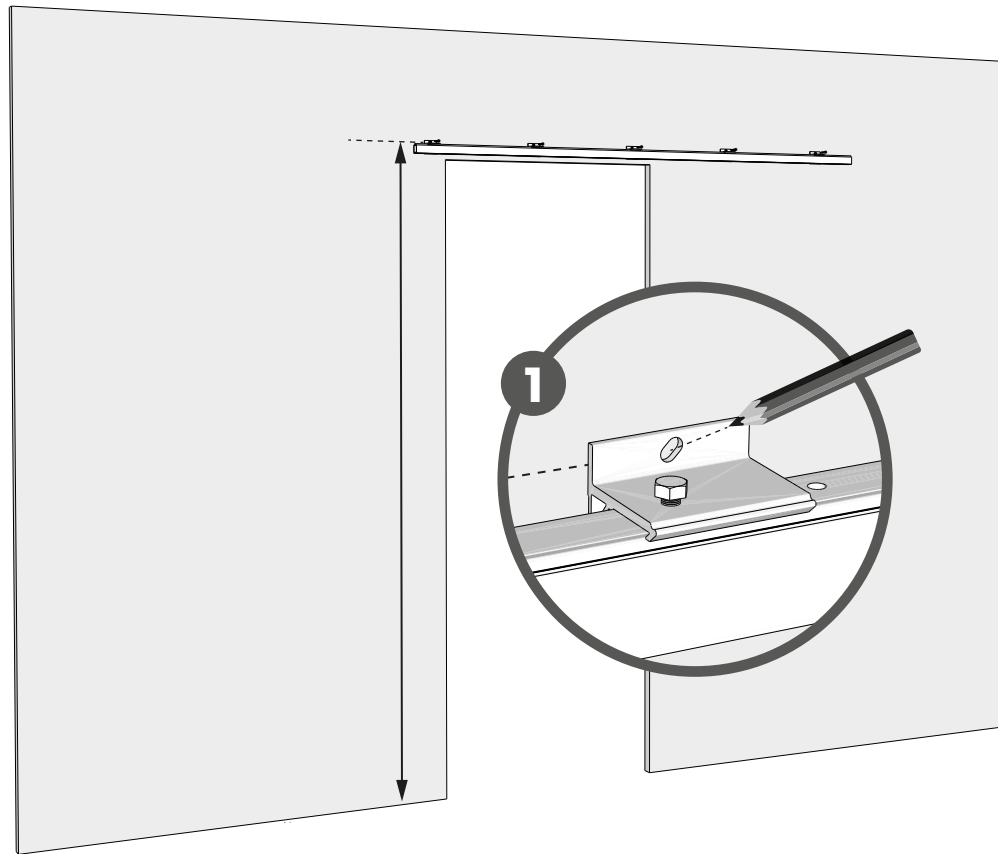
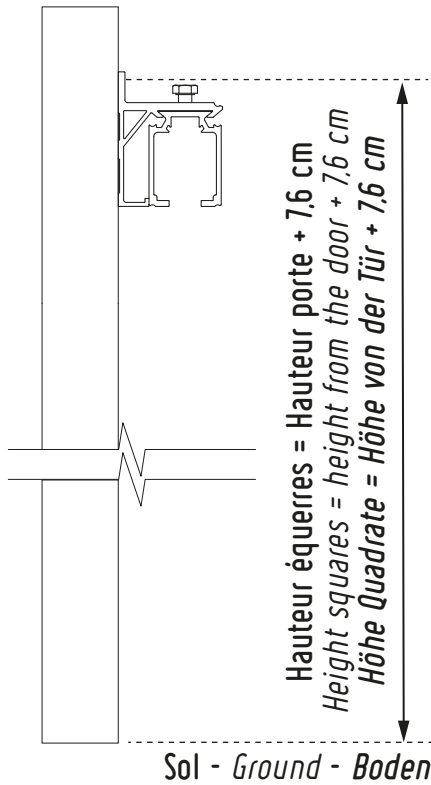
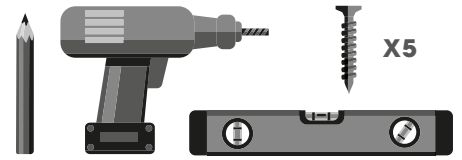

Fixation non fournie, à adapter à votre support.  
Screw (not provided) to adapt accordingly to your support.  
Befestigung nicht inklusiv, Befestigung entsprechend dem Träger organisieren.

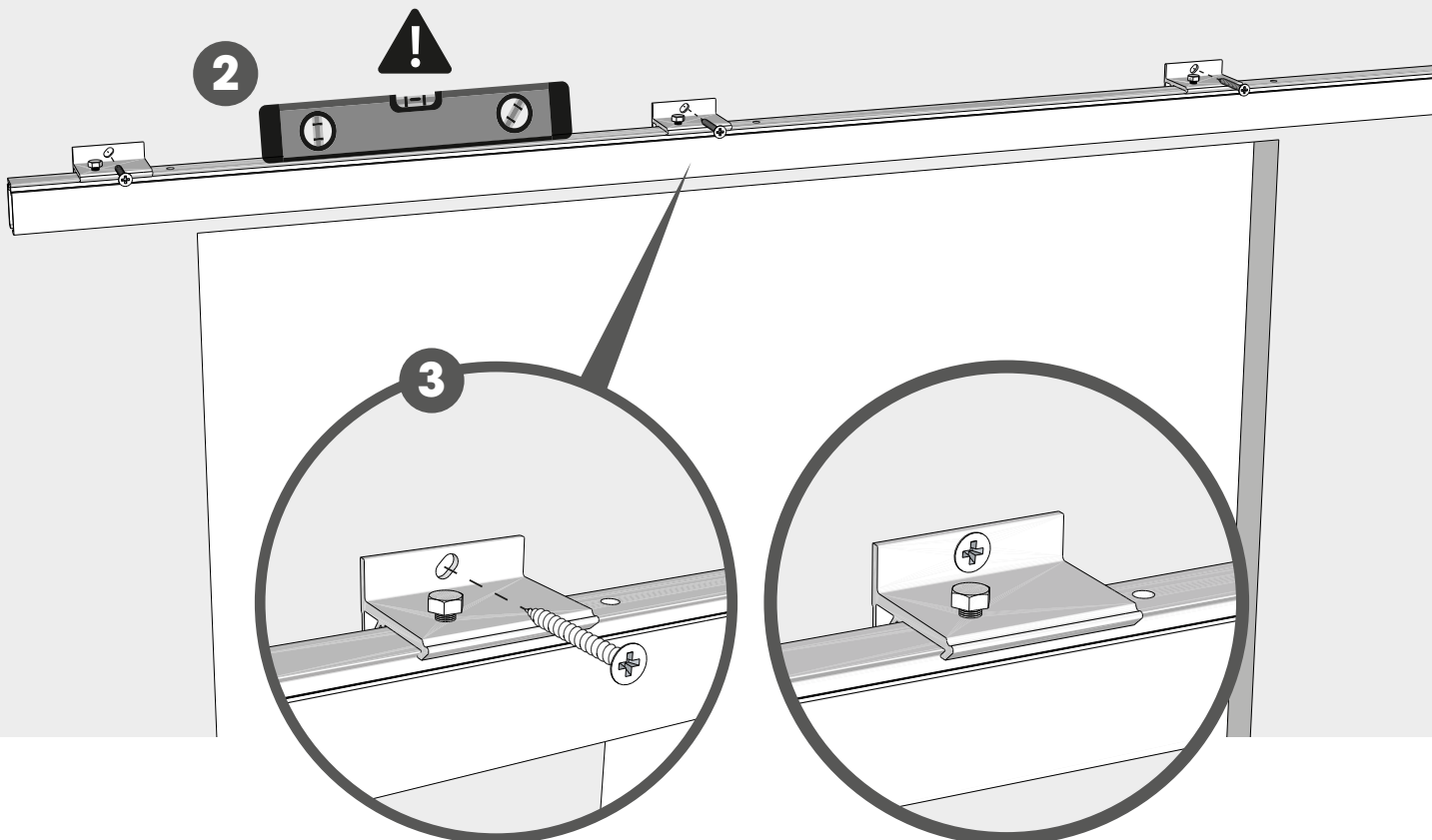

# ÉTAPE 4 - STEP 4 - SCHRITT 4



13 mm

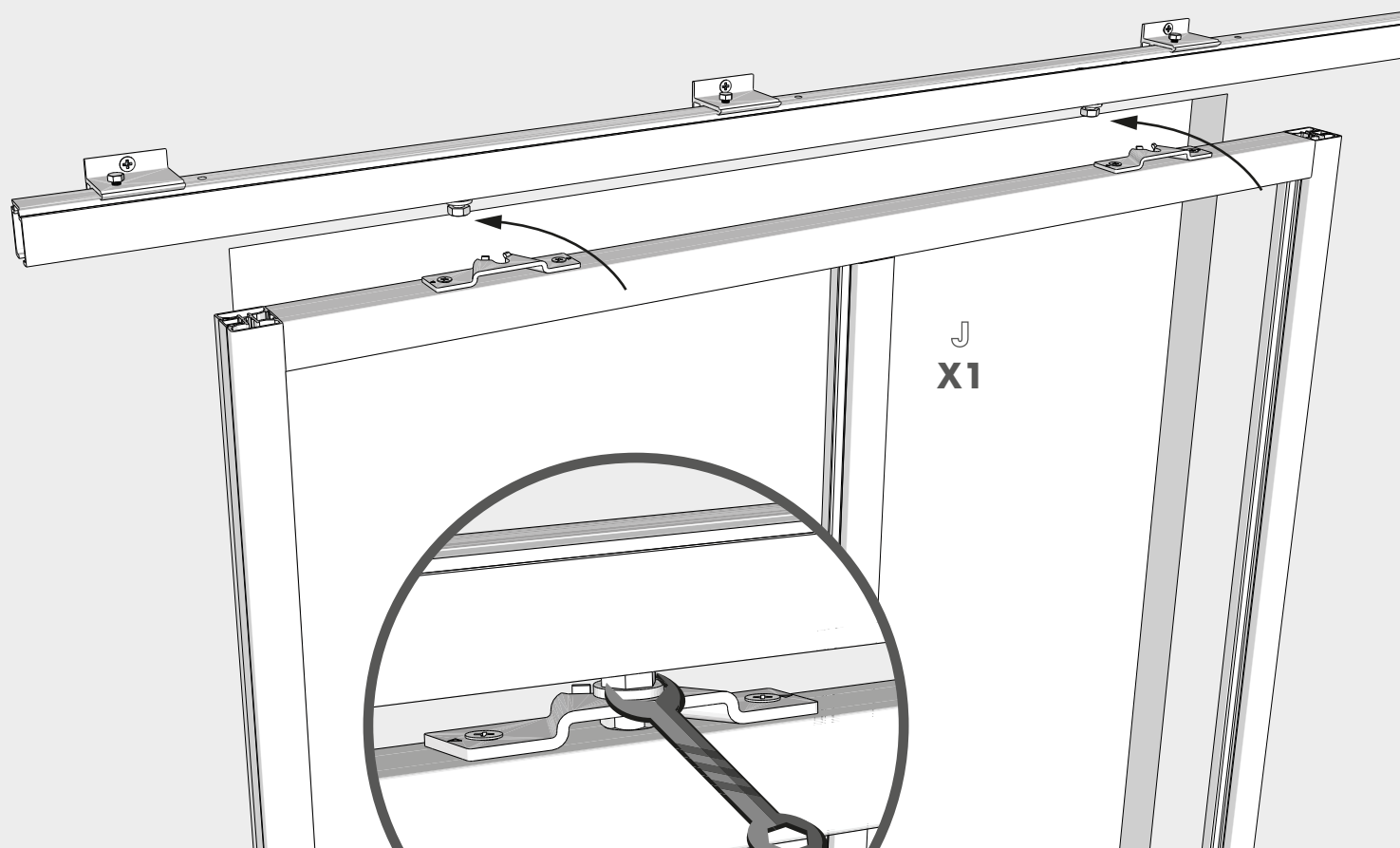
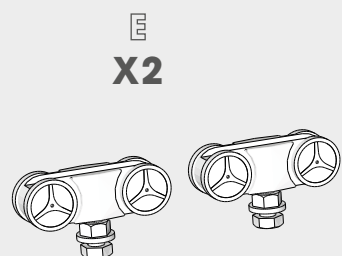

**J**  
**X1**

13 mm

# ÉTAPE 5 - STEP 5 - SCHRITT 5

3 mm  
4 mm

F  
X1

1

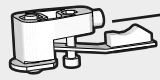

Porte en position fermée  
Door closed position  
Position der Tür geschlossen

2

Porte en position fermée  
Door closed position  
Position der Tür geschlossen

3

4 mm 3 mm

Ouvrez la porte pour serrer la butée.  
Open the door to tighten the stop.  
Öffnen Sie die Tür um den Anschlag fest zu ziehen.

# ÉTAPE 6 - STEP 6 - SCHRITT 6

3 mm  
4 mm

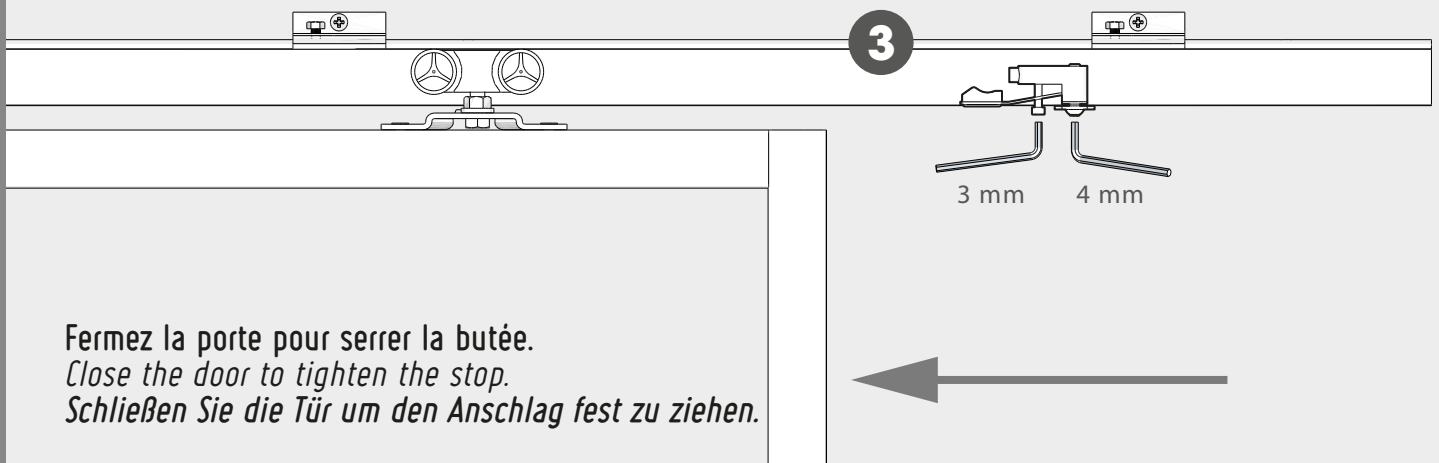
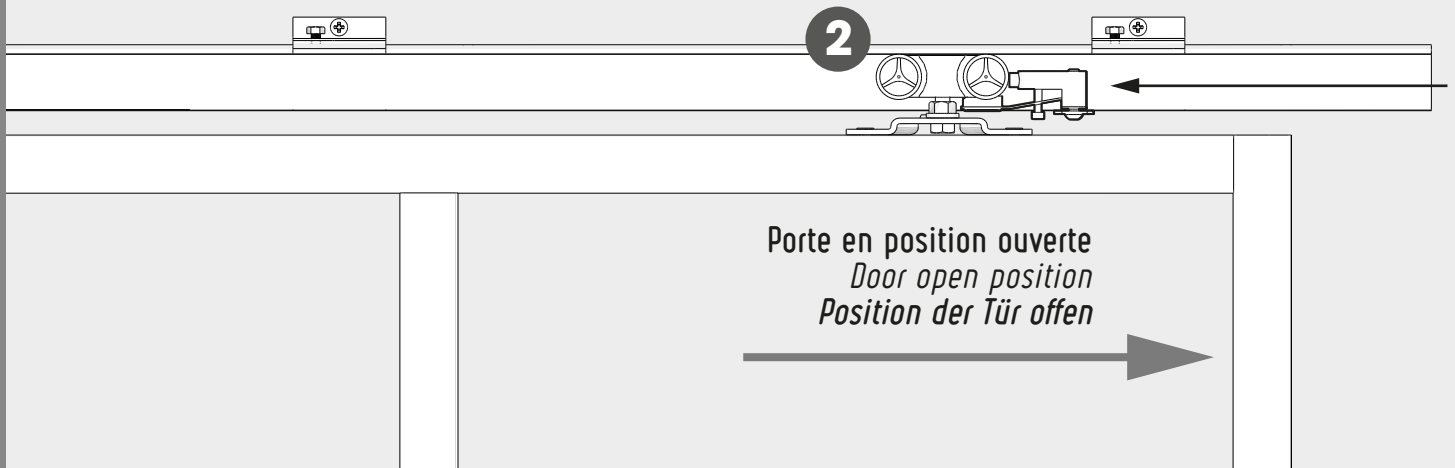
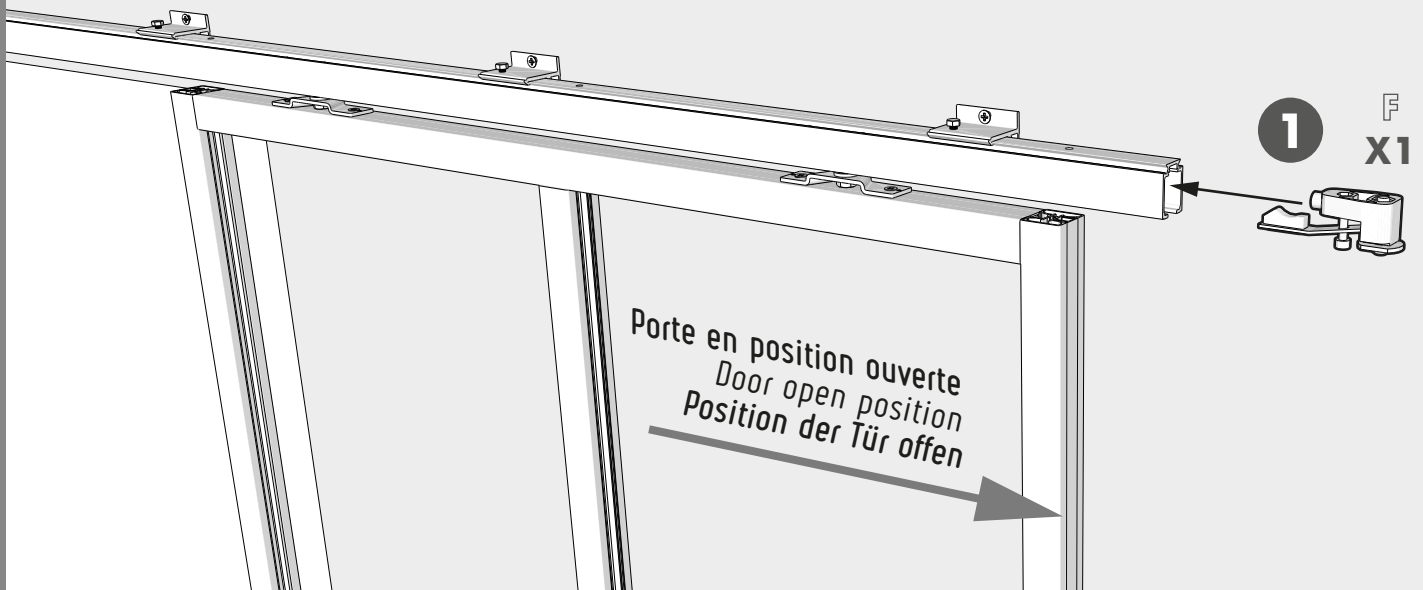

# ÉTAPE 7 - STEP 7 - SCHRITT 7

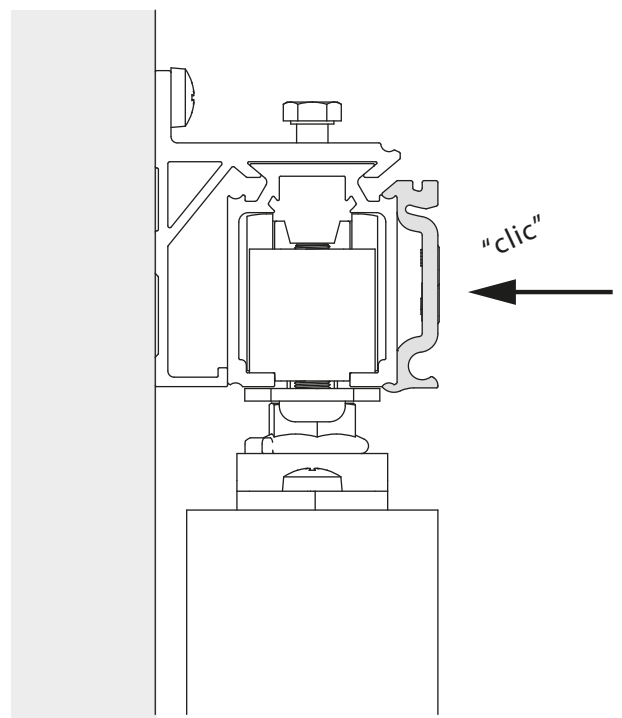
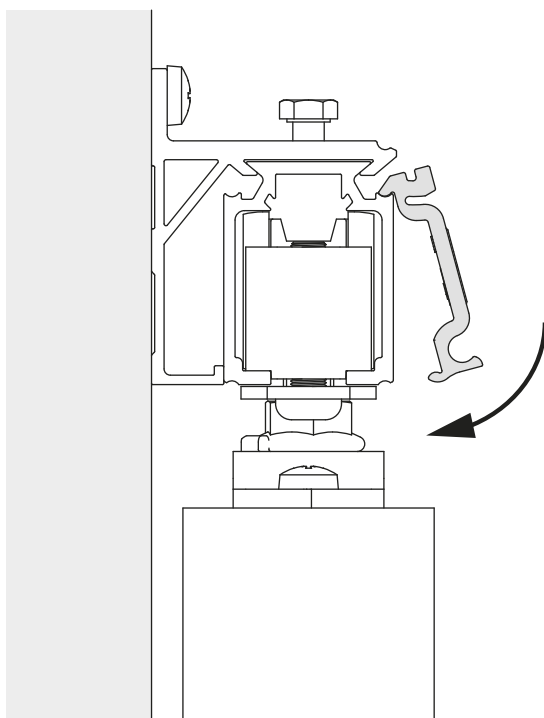
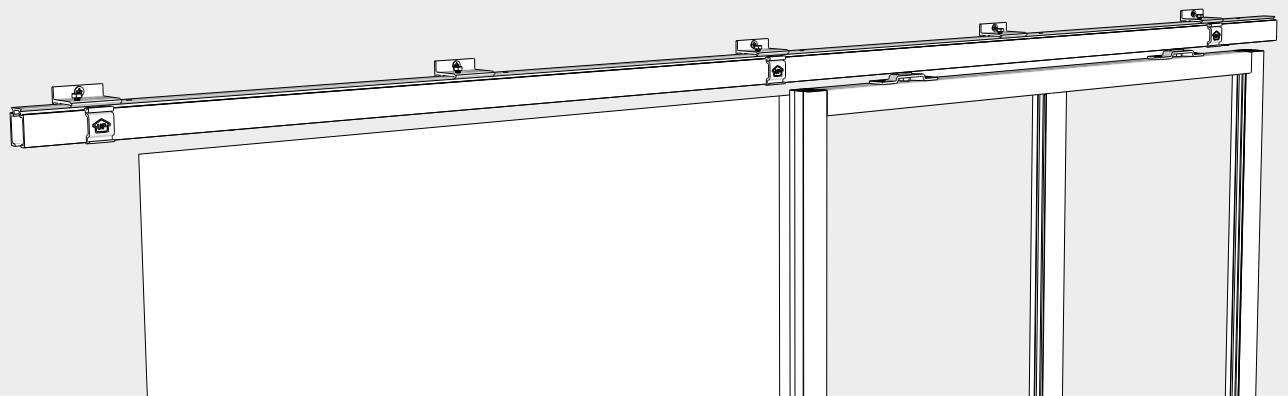
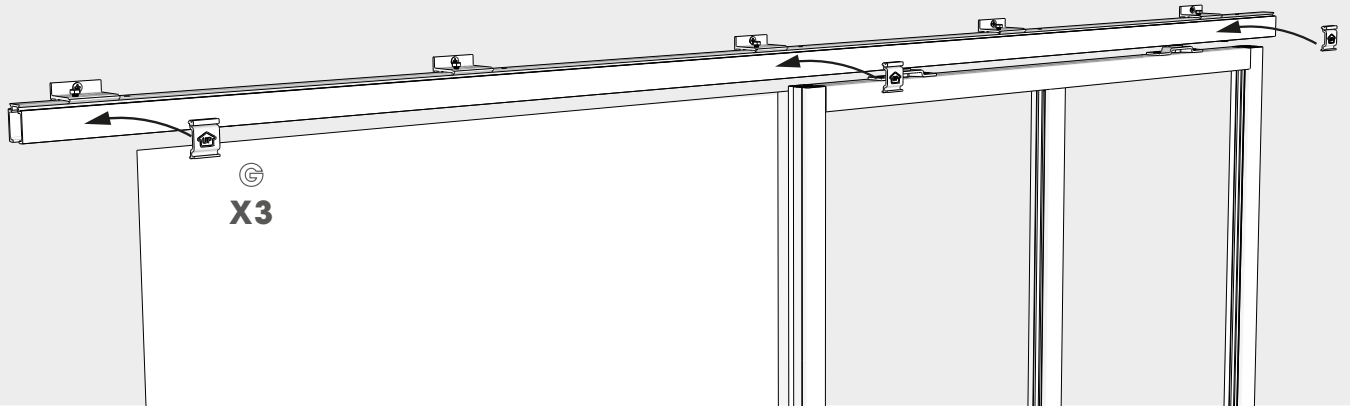

# ÉTAPE 8 - STEP 8 - SCHRITT 8

A  
X1

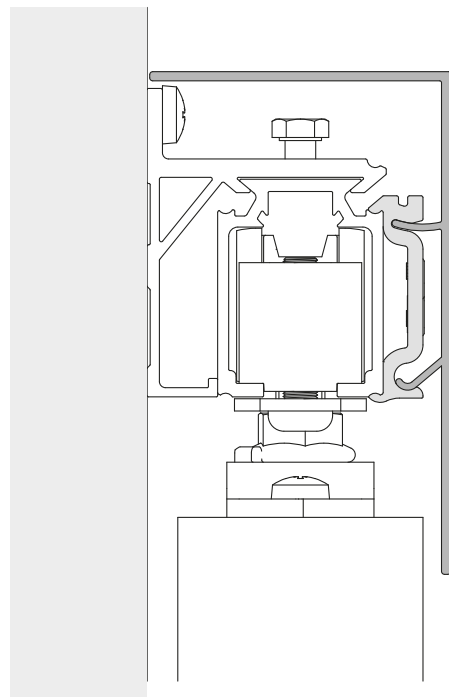
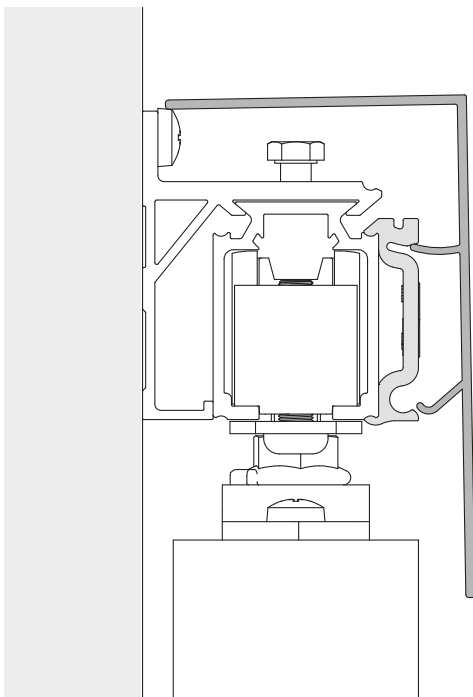
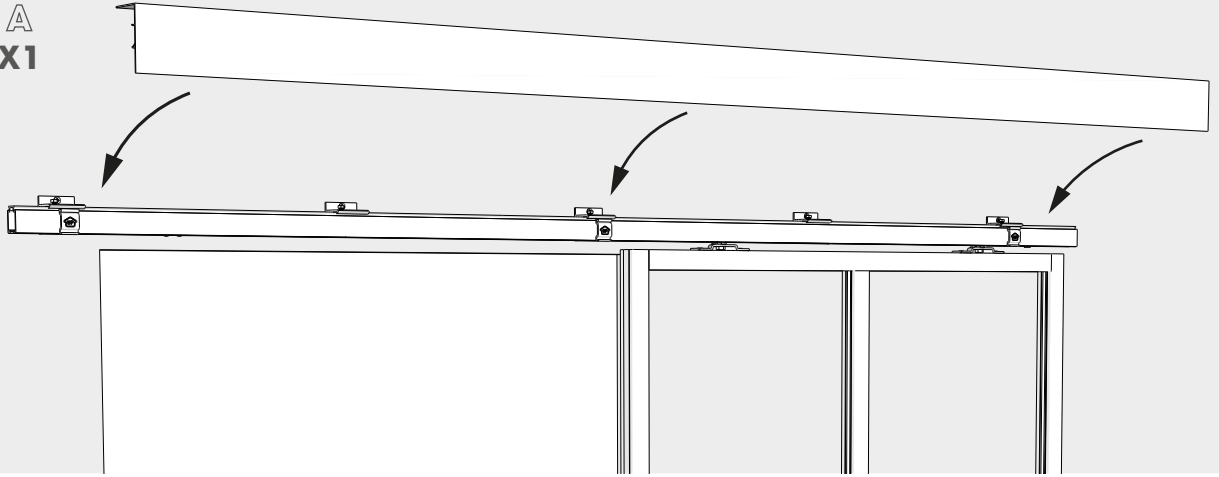

"clac"



## ÉTAPE 9 - STEP 9 - SCHRITT 9

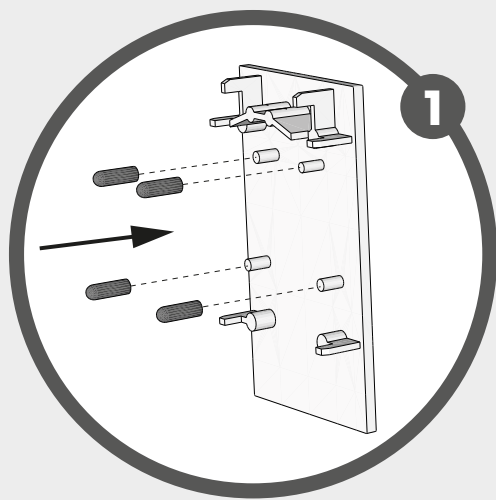

H  
X1

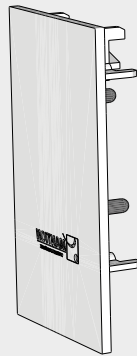

2

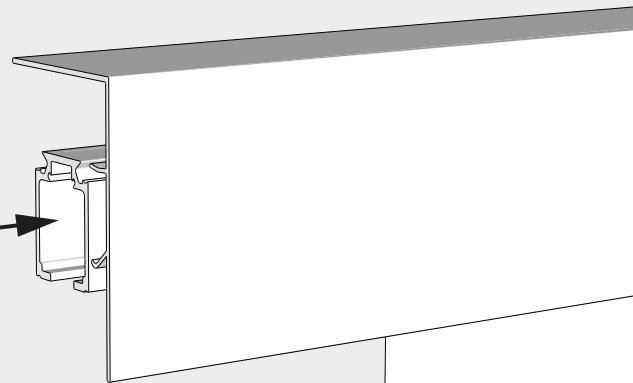

Répétez ces opérations pour le cache de droite.  
Repeat these operations for the right side.  
Wiederholen Sie die Manipulation für die rechte Seite.

## ÉTAPE 10 - STEP 10 - SCHRITT 10

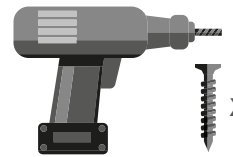

X2

Porte en position ouverte  
Door open position  
Position der Tür offen



1  
i  
X1

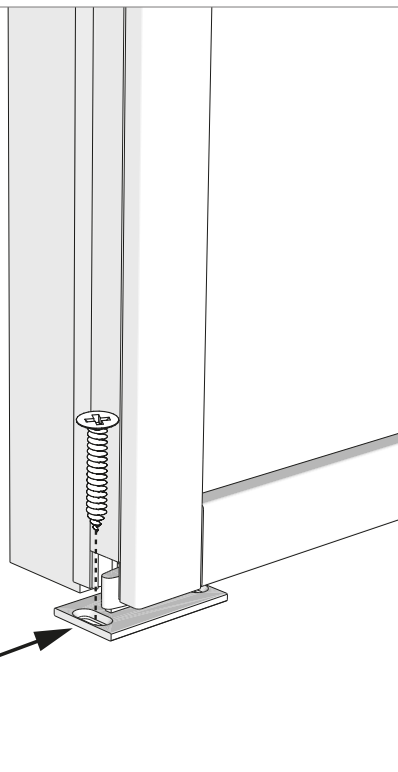
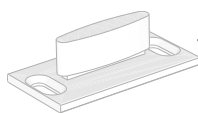

Porte en position fermée  
Door closed position  
Position der Tür geschlossen



2

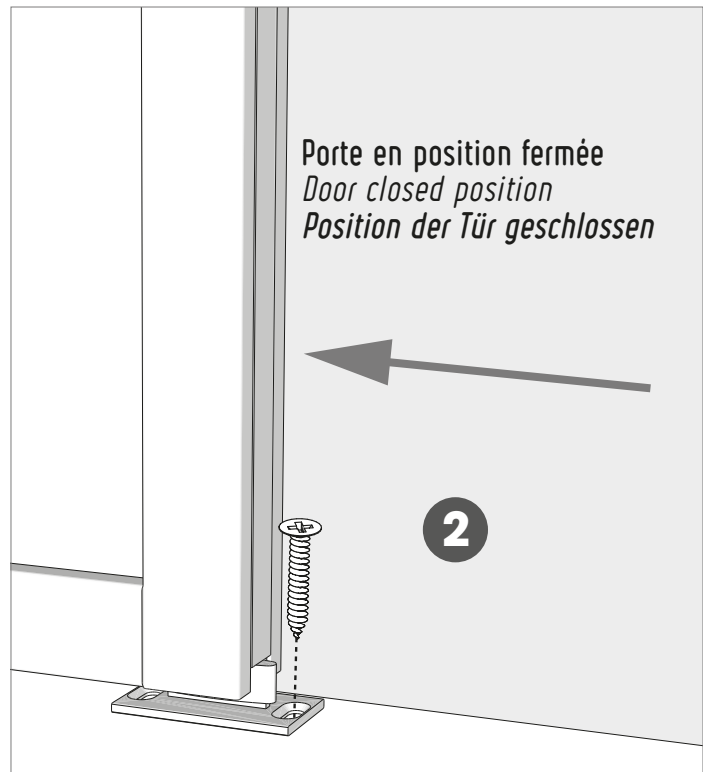

Fixation non fournie, à adapter à votre support.  
Fixation (not provided) to adapt accordingly to your support.  
Befestigung nicht inklusiv, Befestigung entsprechend dem Träger organisieren.

